

## DIFFERENTIAL PRESSURE TRANSMITTER DPT-2wire EIGHT RANGE MODEL



### Model summary

Each device has 8 jumper selectable measuring ranges. Each device is individually temperature compensated.

Model: **DPT-2W-2500-R8 (-D)**  
**DPT-2W-7000-R8 (-D)**

- R8 for 8 measuring range
- D for display

*long term stability typical 1 year*  
*≤ ± 8 Pa; model 2500*  
*≤ ± 24 Pa; model 7000*

Model 2500	Model 7000
-100...+100 Pa	0...1000 Pa
0...100 Pa	0...1500 Pa
0...250 Pa	0...2000 Pa
0...500 Pa	0...2500 Pa
0...1000 Pa	0...3000 Pa
0...1500 Pa	0...4000 Pa
0...2000 Pa	0...5000 Pa
0...2500 Pa	0...7000 Pa

The Differential Pressure Transmitter is delivered individually packed with standard accessories (see accessories).

# HK INSTRUMENTS Ltd

Keihästie 7  
FIN-40950 MUURAME  
FINLAND

[www.hkinstruments.fi](http://www.hkinstruments.fi)

Tel. +358 14 337 2000  
Fax. +358 14 337 2020  
Email: [info@hkinstruments.fi](mailto:info@hkinstruments.fi)

Bank: Leonia 800019-01847385  
Vat Reg: FI 06730729  
Reg no: 404.989

## Technical data

<b>Response Time</b>	0.8 / 4 s selectable by push button (see instructions below)	
<b>Bursting pressure</b>	30 kPa (model 2500) 80 kPa (Model 7000)	
<b>Suitable media</b>	Air and non-aggressive gases	
<b>Measuring element</b>	Piezoresistive	
<b>Electrical interface (2-wire)</b>	Supply voltage	10...35 V DC
	Max. supply current	32 mA
	Output signal	4...20 mA
	Max. output current	32 mA
	Maximum load	$= \frac{\text{Supply} - 10V}{0,020A}$
<b>Materials</b>	Housing	ABS
	Cover	PC
	Pressure connections	ABS
	Duct connectors	ABS
	Tubing	PVC, soft
<b>Connections</b>	Electrical connections	2 screw terminals, max 1,5 mm <sup>2</sup>
	Cable entry	M16x1,5, cable Ø 4..8 mm
	Pressure connections	Male Ø 5,0 mm and 6,3 mm
<b>General ambient conditions</b>	Temperature range	
	Operation	-10...+50°C
	Storage	-20...+70°C
	Ambient humidity	0 to 95% RH
<b>Weight</b>	150 grams, with accessories 290 grams	
<b>Dimensions</b>	90,0 x 71,5 x 36,0 mm	
<b>Safety</b>	Protection standard	IP54
	Conformance	Meets the requirements for CE marking: EMC directive 89/336/EEC Rohs Directive 2002/95/EY

## Accessories

Standard accessories:

- 2 fixing screws
- 2 plastic duct connectors
- 2 m tube Ø 4 / 7 mm

Optional accessories:

- Metallic duct connectors

# HK INSTRUMENTS Ltd

Keihästie 7  
FIN-40950 MUURAME  
FINLAND

[www.hkinstruments.fi](http://www.hkinstruments.fi)

Tel. +358 14 337 2000  
Fax. +358 14 337 2020  
Email: [info@hkinstruments.fi](mailto:info@hkinstruments.fi)

Bank: Leonia 800019-01847385  
Vat Reg: FI 08730729  
Reg no: 404.989

## Zero-point adjustment

**Note!** Supply voltage must be connected one hour before the 0-point adjustment is carried out.

- 1) Loose both tubes from the pressure inlets + and –
- 2) Push zero button until the red led turns ON.
- 3) Wait until LED turns off and then install tubes again to the pressure inlets

It is recommended to adjust the zero point every 12 months during normal operation.

## Dimensions

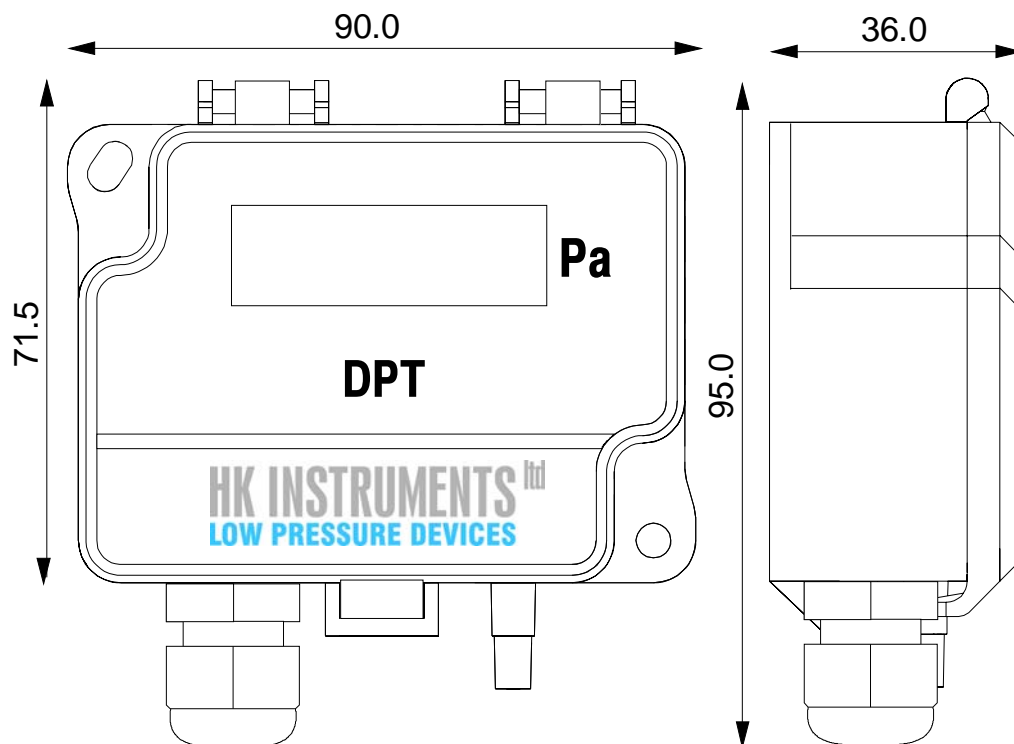

# HK INSTRUMENTS Ltd

Keihästie 7  
 FIN-40950 MUURAME  
 FINLAND  
 Tel. +358 14 337 2000 Bank: Leonia 800019-01847385  
 Fax. +358 14 337 2020 Vat Reg: FI 06730729  
 Email: info@hkinstruments.fi Reg no: 404.989

## Installation

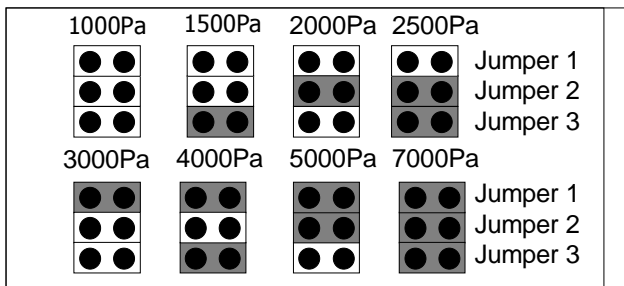
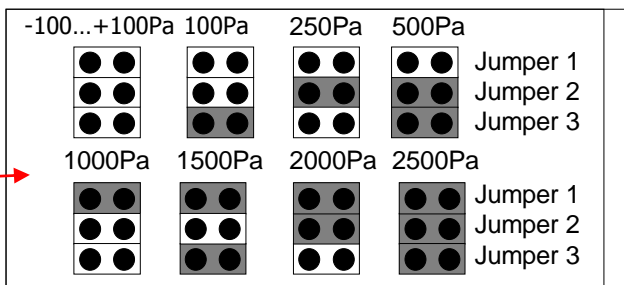
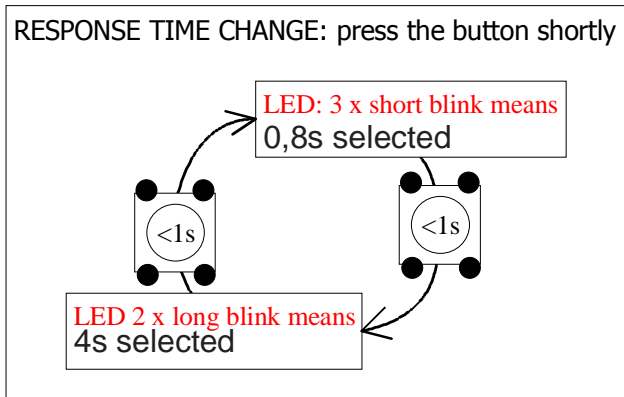
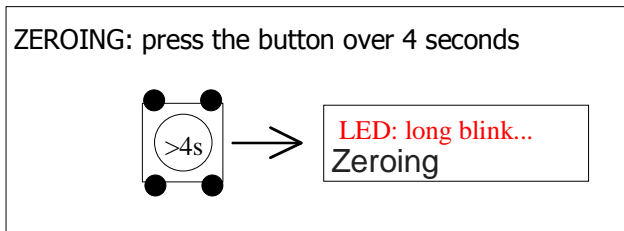
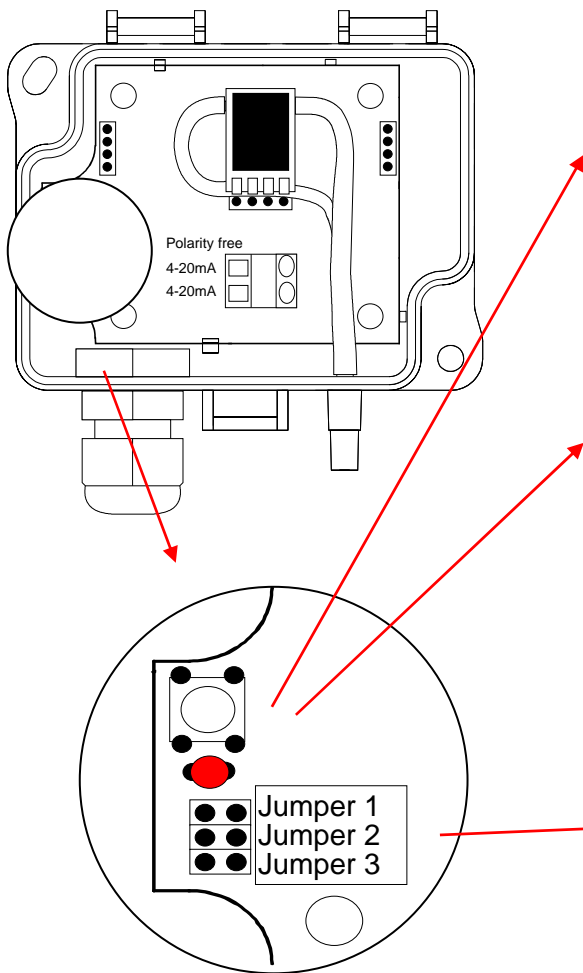

### Electrical Connection:

Polarity free power supply  
 1 Current loop + or -  
 2 Current loop + or -

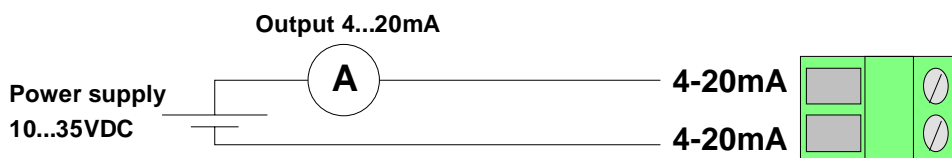

**POLARITY FREE**